

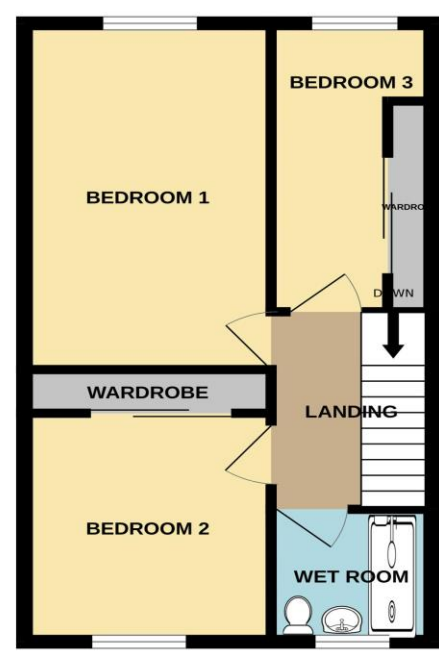

GROUND FLOOR



1ST FLOOR



Whilst every attempt has been made to ensure the accuracy of the floorplan contained here, measurements of doors, windows, rooms and any other items are approximate and no responsibility is taken for any error, omission or mis-statement. This plan is for illustrative purposes only and should be used as such by any prospective purchaser. The services, systems and appliances shown have not been tested and no guarantee as to their operability or efficiency can be given.  
Made with Metropix ©2024

**Wainwright Estates**  
10 The Precinct, London Road  
Waterlooville, Hampshire PO7 7DT

**Tel: 02392 264500**  
Email: [sales@wainwrightestates.co.uk](mailto:sales@wainwrightestates.co.uk)  
[www.wainwrightestates.co.uk](http://www.wainwrightestates.co.uk)



**24 Atlantis Avenue**  
Crookhorn, Waterlooville PO7 8AS

**Price: £275,000**

### DESCRIPTION

This spacious, three bedroom, end of terrace property is located on the outskirts of Crookhorn, Waterlooville. Internally the property boasts generous sized accommodation comprising of a fitted kitchen opening into your lounge. There is also a handy home office, downstairs cloakroom and a double glazed conservatory overlooking your low maintenance rear garden. Upstairs you will find three well proportioned bedrooms for the growing family and a wet room. The property is offered with no forward chain and is available for viewings immediately.

### ACCOMMODATION

ENTRANCE HALL

WC

OFFICE/STORAGE AREA: 5' 8" x 5' 7" (1.73m x 1.70m)

KITCHEN/BREAKFAST ROOM: 14' 1" x 8' 9" (4.29m x 2.66m)

LOUNGE: 15' 7" x 14' 2" (4.75m x 4.31m)

CONSERVATORY: 9' 9" x 6' 8" (2.97m x 2.03m)

### FIRST FLOOR

BEDROOM 1: 14' 8" x 8' 8" (4.47m x 2.64m)

BEDROOM 2: 10' 4" x 8' 8" (3.15m x 2.64m)

BEDROOM 3: 12' 8" x 5' 8" (3.86m x 1.73m)



WET ROOM: 5' 8" x 5' 8" (1.73m x 1.73m)

### OUTSIDE

FRONT & REAR GARDEN

